

GRAPEVINE MEDICAL PARK

SWC OF WILLIAM D TATE AVE & IRA WOODS AVE, GRAPEVINE, TX 76051

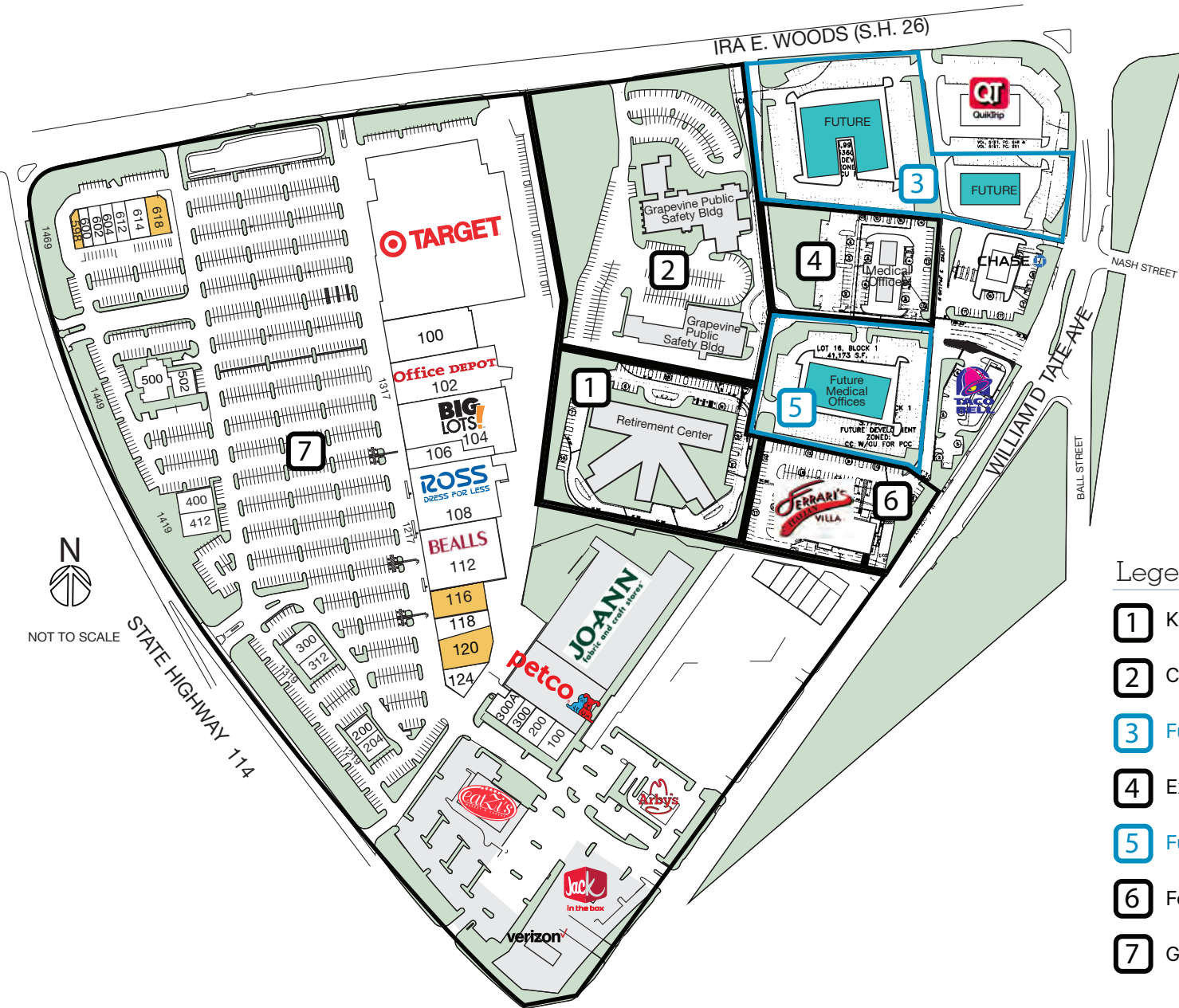

Legend

- 1** Kindred Transitional Care & Rehab
- 2** City of Grapevine Fire Public Safety Offices
- 3** Future Development - 4.8123 AC
- 4** Existing Medical Condo Offices
- 5** Future Development - 3.1711 AC
- 6** Ferrari's Italian Villa
- 7** Grapevine Towne Center

NOT TO SCALE



STATE HIGHWAY 114

The information was obtained from sources deemed reliable; however, Weitzman has not verified it and makes no guarantees, warranties or representations as to the completeness or accuracy thereof. The presentation of this real estate information is subject to errors; omissions; change of price; prior sale or lease, or withdrawal without notice. You and your advisors should conduct a careful independent investigation of the property to determine if it is suitable for your intended purpose.