

ARLINGTON PROFESSIONAL PLAZA | 801 W ROAD TO SIX FLAGS, ARLINGTON, TX 76012

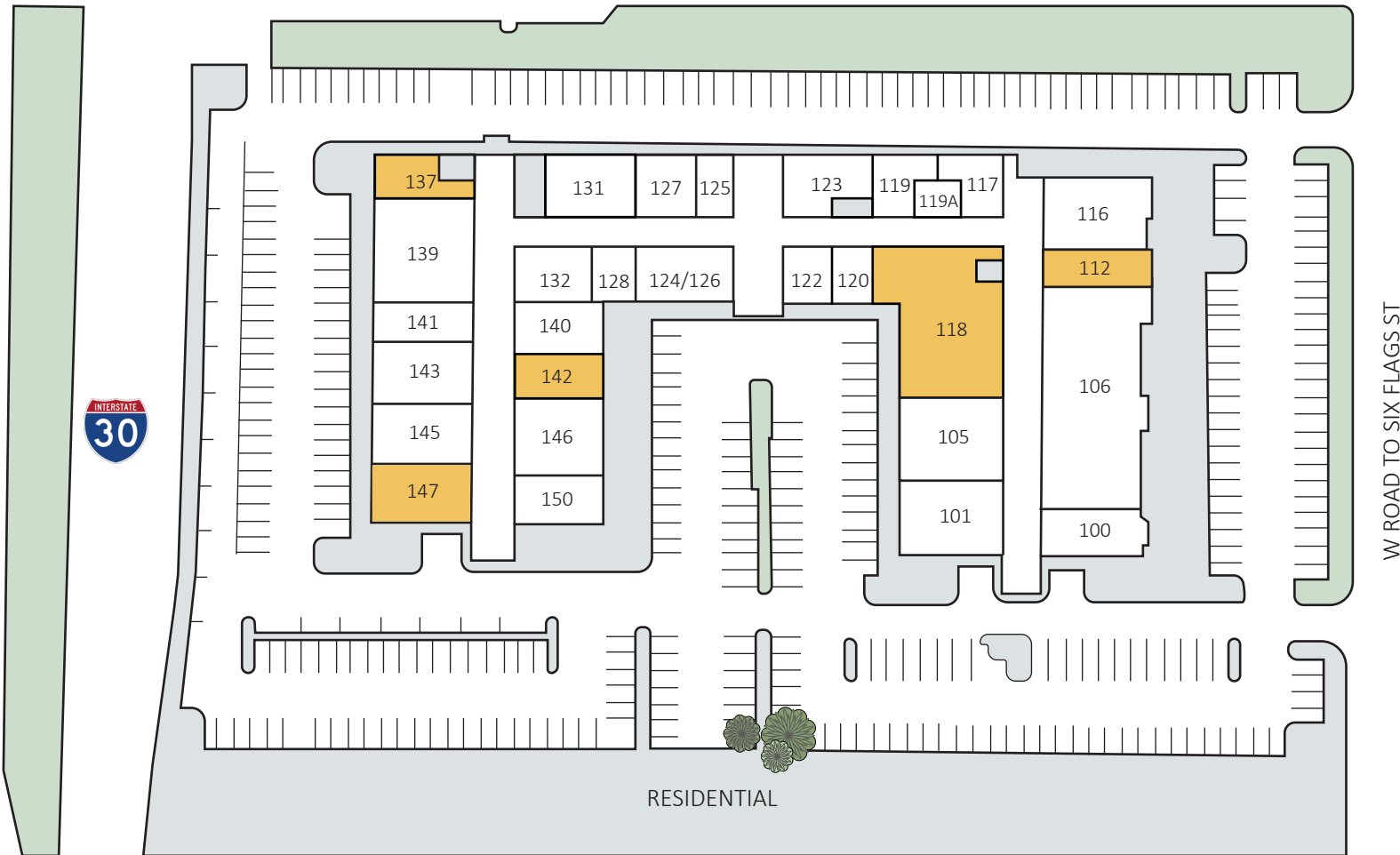

Available Space	
112	1,645 sf
118	5,720 sf
137	2,040 sf
142	1,815 sf
147	2,191 sf

Current Tenants

100	Serene Smile Dentistry	1,336 sf	120	Infinity Wellness Group	902 sf	132	Phoenix Associates Counseling	2,053 sf
101	Fundentis-Pediatric & Adolescent Dentistry	2,781 sf	122	Mercy Care Pharmacy	1,158 sf	139	Arlington Dermatology	3,139 sf
105	Premier Physical Therapy	3,200 sf	123	Dr. Andrew Segal	1,699 sf	140	Arlington Physicians	3,139 sf
106	Envision Imaging	7,913 sf	124/126	Dr. Andrew Klymiuk	2,105 sf	141	Health First Injury & Pain Center	1,664 sf
116	Covenant Women's Health	2,625 sf	125	Associates of Family Psychiatry	912 sf	143	Ted French, DDS	2,394 sf
117	Atlas Genomics	1,459 sf	127	Neurology & Movement Disorders Center of North Texas	1,546 sf	145	Dr. Hemat Day	1,827 sf
119	TREX Surgical Lab	1,955 sf	128	Love Family Healthcare	907 sf	146	Nextgen Wellness Clinic	3,197 sf
			131	Cornea Consultants	3,209 sf	150	Fusion Foot & Ankle	1,143 sf

The information was obtained from sources deemed reliable; however, Weitzman has not verified it and makes no guarantees, warranties or representations as to the completeness or accuracy thereof. The presentation of this real estate information is subject to errors; omissions; change of price; prior sale or lease, or withdrawal without notice. You and your advisors should conduct a careful independent investigation of the property to determine if it is suitable for your intended purpose.